



STARR
POWER TONGS

9-7/8" 60 SPECIFICATIONS

9-7/8" 60-BR



TORQUE - Rineer 21IN ³ 60K Tong					RPM - Rineer 21IN ³ 60K Tong				
Press.	Speed 1	Speed 2	Speed 3	Speed 4	GPM	Speed 1	Speed 2	Speed 3	Speed 4
	ft.-lb.	ft.-lb.	ft.-lb.	ft.-lb.					
1000	24,815	4,377	12,407	2,188	10	0.9	5	1.8	10.1
2000	49,630	8,754	24,815	4,377	20	1.8	10.1	3.6	20.2
2250	55,834	9,848	27,917	4,924	40	3.6	20.2	7.1	40.4
2500	62,037	10,942	31,019	5,471	60	5.3	30.3	10.7	60.6
2750	-	12,036	34,121	6,018					
3000	-	13,130	37,222	6,565					

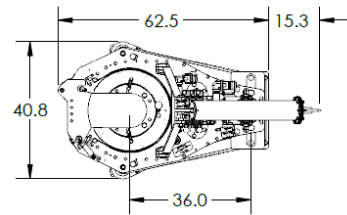

NOTE – 2 Options Available
9-7/8" 60 – (1 Handle – 2 Capped Valves)
9-7/8" 60-BR (Ready to Receive 10-3/4 Backup)

	Motor Shift	Tong Transmission Shift
Speed 1	Low Gear	Low Gear
Speed 2	Low Gear	High Gear
Speed 3	High Gear	Low Gear
Speed 4	High Gear	High Gear

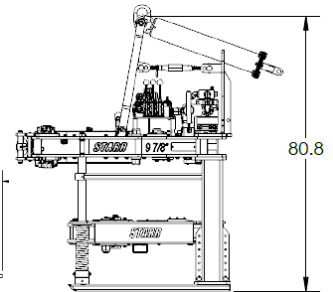
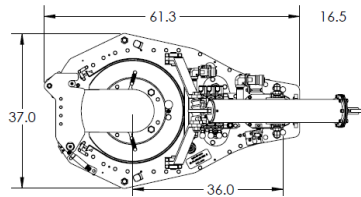

	9 7/8" Tong	9 7/8" Tong w/ Backup
Width	37" (94 cm)	40.8" (103.6 cm)
Length	61.3" (155.7 cm)	62.5" (158.8 cm)
Height	47.5" (120.6 cm)	78.9" (200.4 cm)
Weight	2,150lb. (977kg)	3,300lb. (1,500kg)
Rated Pressure	2500 psi	
Rated Torque	60,000 ft.-lbs.	
Handle Length	36" (91.4 cm)	

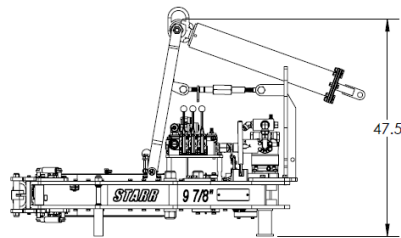

TONG JAWS AVAILABLE: 4 1/2" – 9 7/8"
BACKUP JAWS AVAILABLE: 3 1/2" – 10 3/4"
 (Other sizes available upon request)